

BPK

AXIAL BATHROOM FANS / **Standart**



It is designed to give the air directly to the outside or to send it to the duct. It can provide small and medium volume air movement against low static pressure.

It is quiet and saves energy. The engine has a long life against environmental factors and is resistant to corrosion.

Technical Drawing and Tables

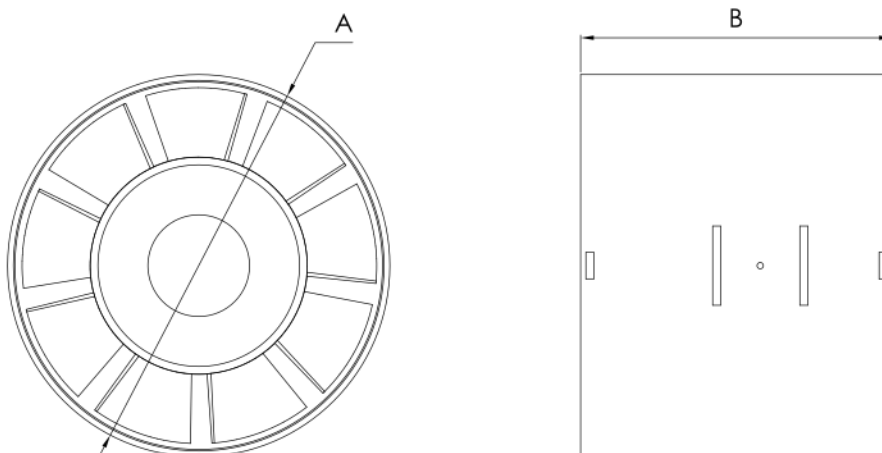

TYPE	A	B
BPK 10	96,5	105,5
BPK 12	117,5	111,5
BPK 15	145	118

Dimensions are in (mm)

TYPE	VOLTAGE	FREQUENCY	POWER	CURRENT	CAPACITOR	SPEED	AIR FLOW	SOUND PRESSURE	INSULATION CLASS	PROTECTION CLASS	WEIGHT	PIECES IN BOX
TYPE	V	Hz	W	(A)	(μF)	r.p.m	m³/h	dB(A)	Ins.cl.	IP	kg	AD
BPK 10	230	50	13	0,09	-	2600	100	40	B	20	0,45	12
BPK 12	230	50	14	0,09	-	2400	200	41	B	20	0,50	12
BPK 15	230	50	21	0,13	-	2000	300	43	B	20	0,55	12

Sound Level Measured from 3m distance in room condition.

Accessories



BSC